



**HOMEHUD**







**Setup**







# Account Setup

1.

Download the HomeBud app and click Sign Up

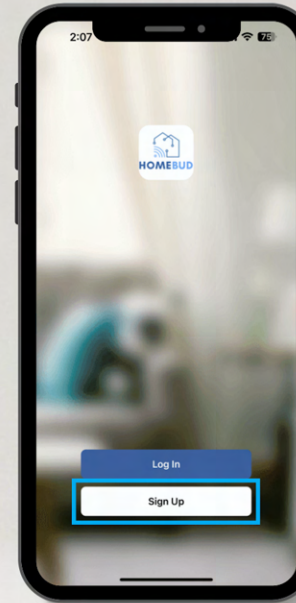

2.

Type in your email address and click Get Verification Code

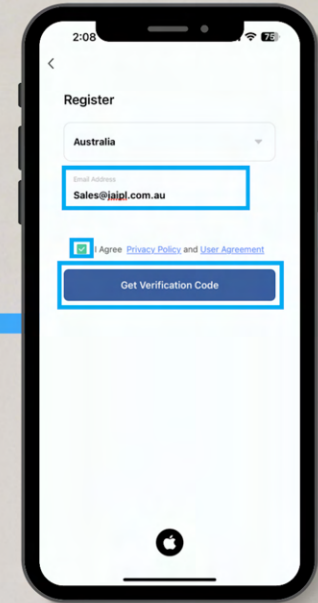

3.

You will receive the verification code via email

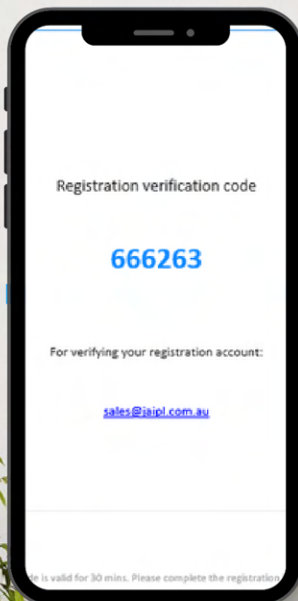

4.

Enter the verification code in HomeBud app



5.

Set your password and click Done

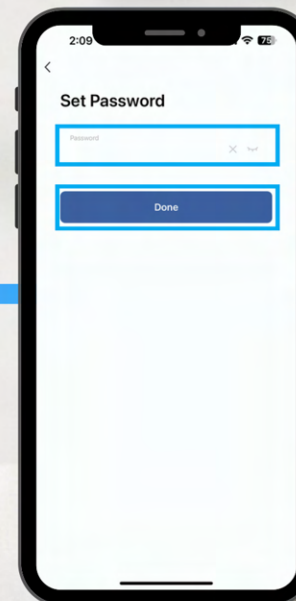

6.

Your account is now setup

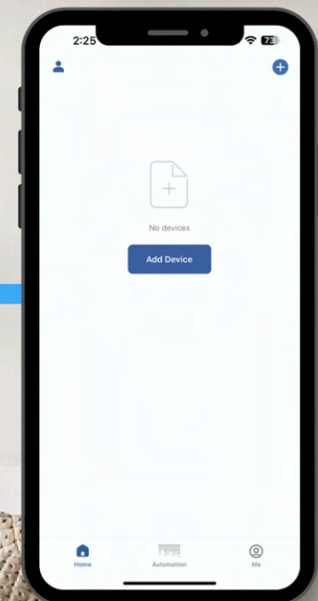





# App Navigation

## Home Screen

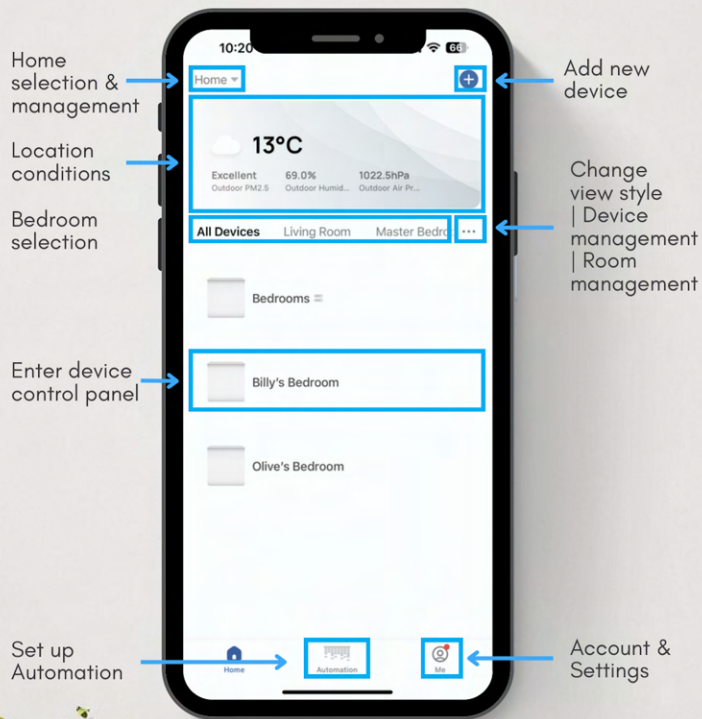

## Automation

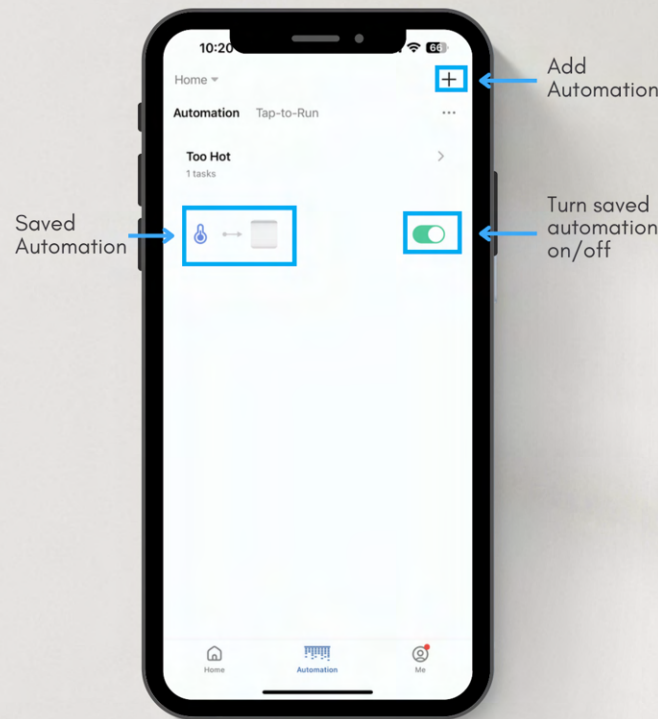

## Me

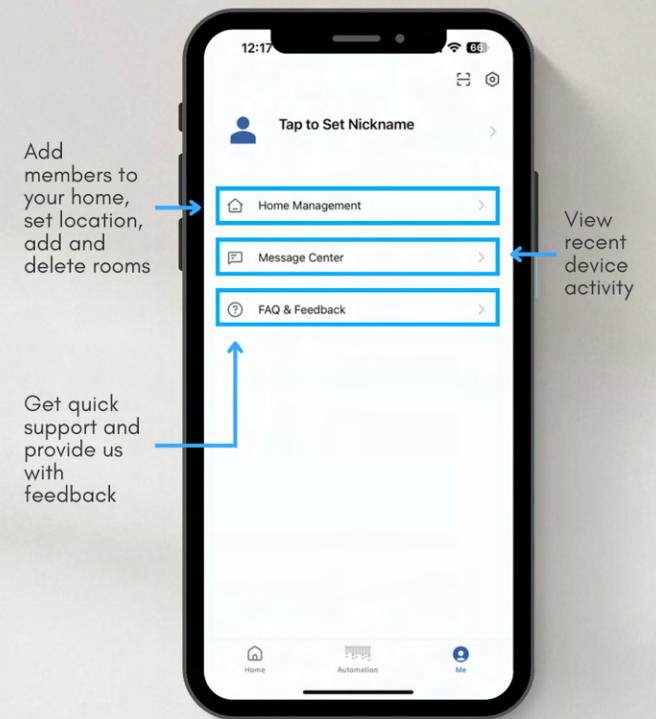





# Create Home

1.



Click on "me" icon

2.

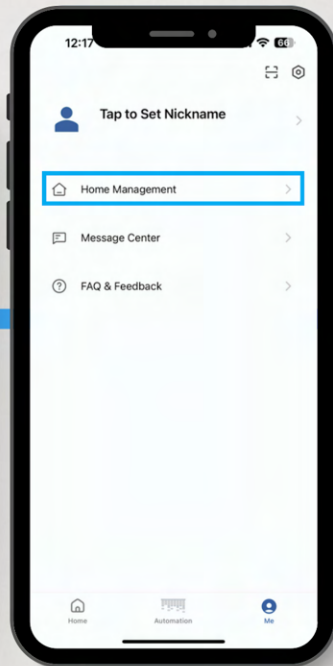

Click Home Management

3.

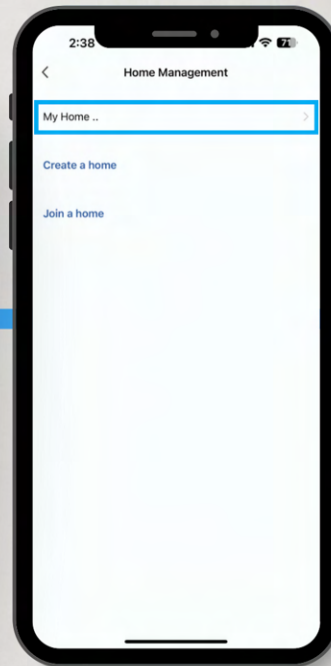

Click on My Home

4.

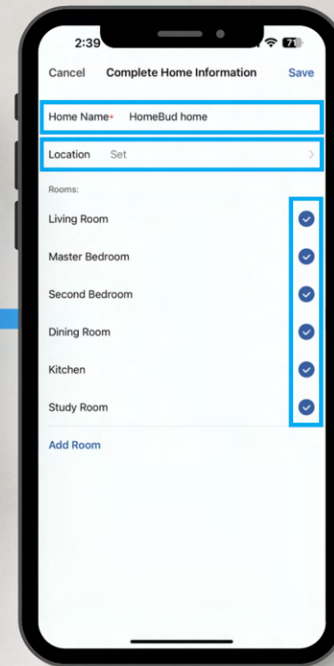

Name your home, then click on set location and follow location settings on next page

5.

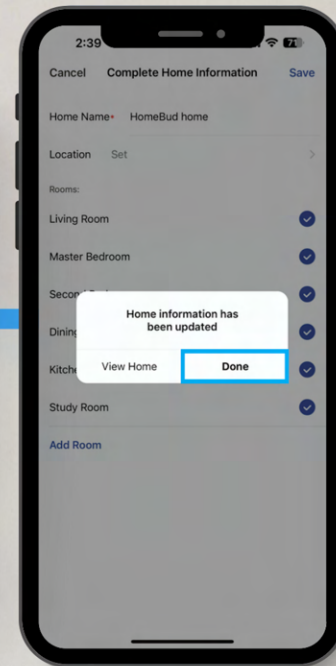

Click Done





# Location Setup

1.



Click on "me" icon

2.

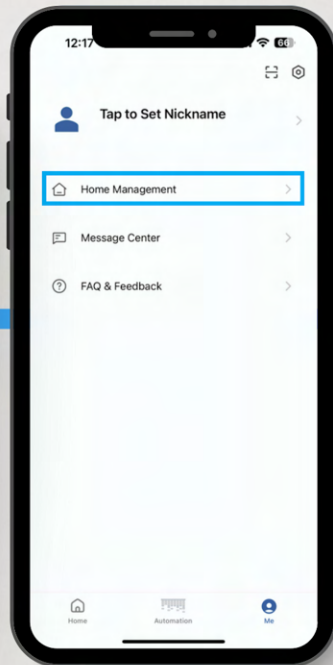

Click Home Management

3.

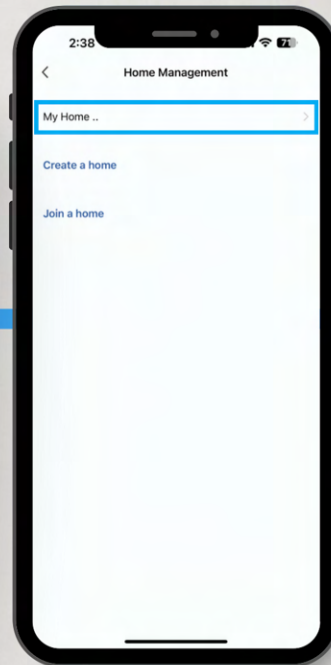

Click on Home

4.

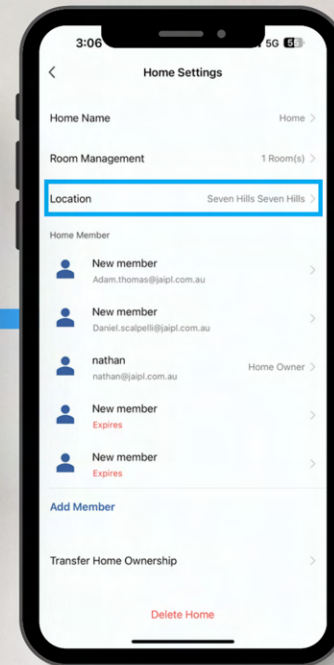

Click on Location

5.

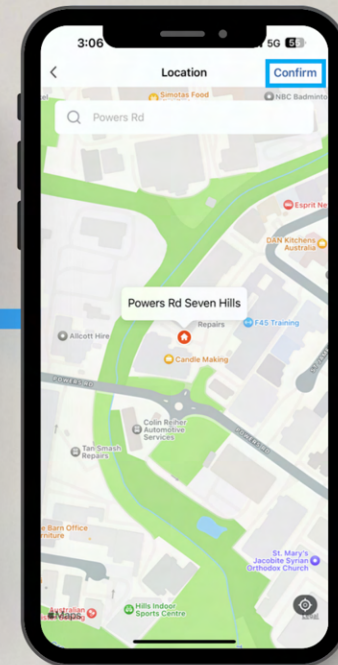

Move the pin to precise location and click confirm





# Adding Users

1.

Click on "me" icon

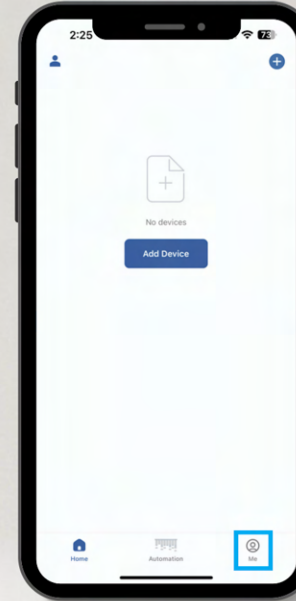

2.

Click Home Management

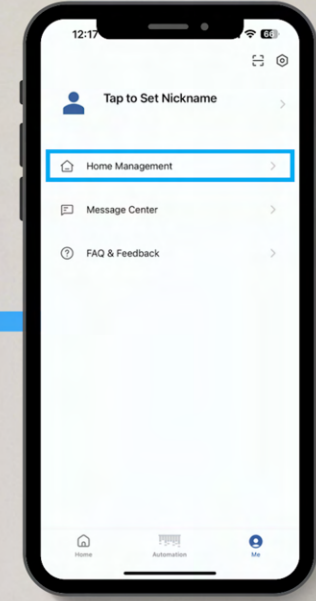

Only home owners will be able to make changes to home management.

3.

Click on Home

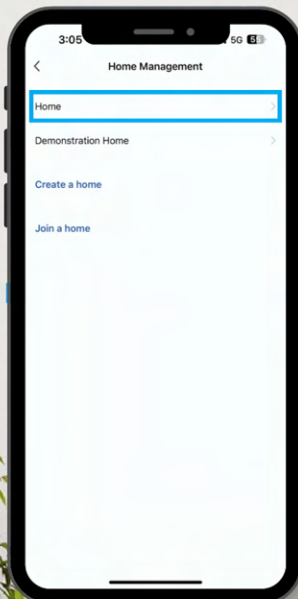

4.

Click on Add Member

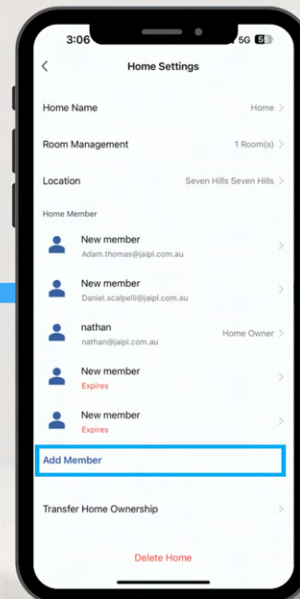

5.

Click messages

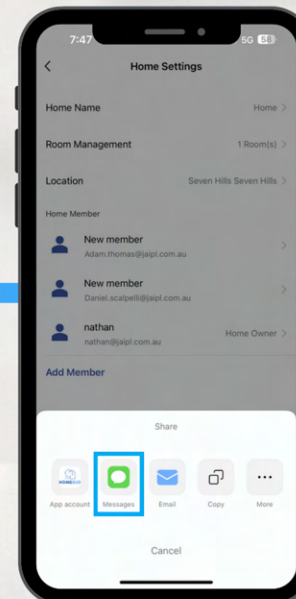

6.

Send message to new home member

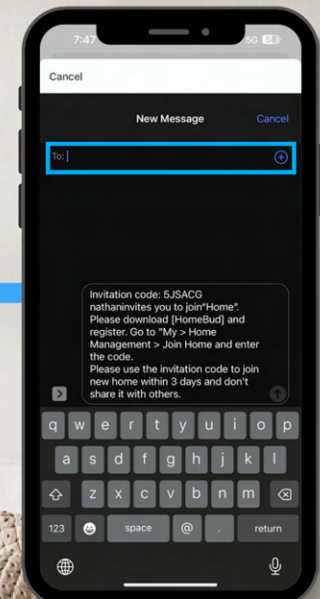





# Transferring home ownership

1.

Click on "me" icon

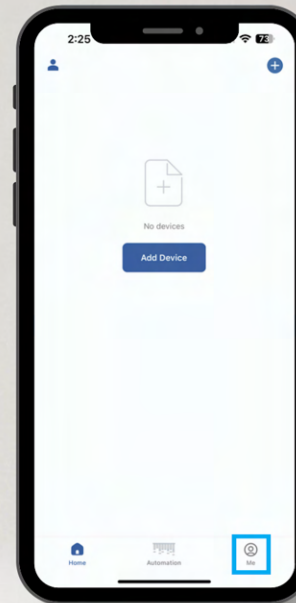

2.

Click Home Management

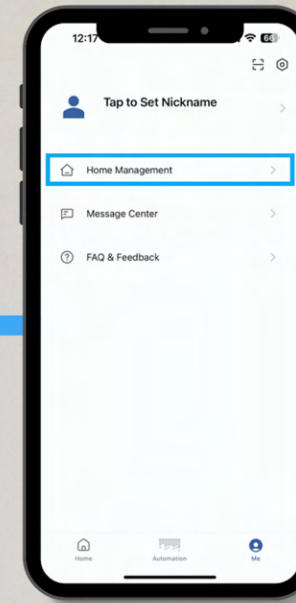

Only the current home owner can change home ownership. To transfer home ownership the new owner needs to be a current user within the home.

3.

Click on My Home

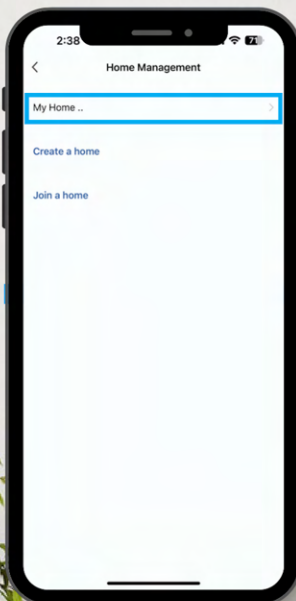

4.

Click Transfer Home Ownership

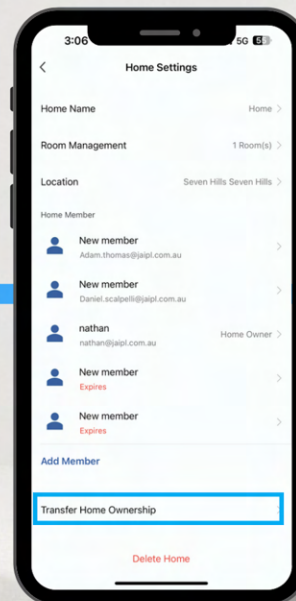

5.

Select new home owner

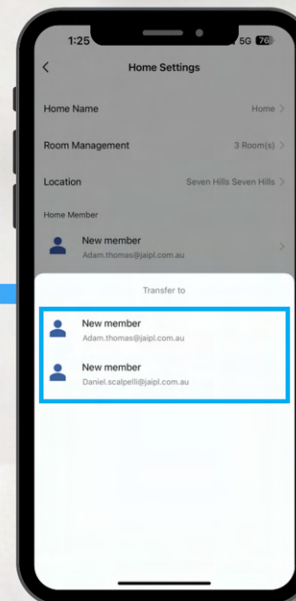

6.

Click Confirm

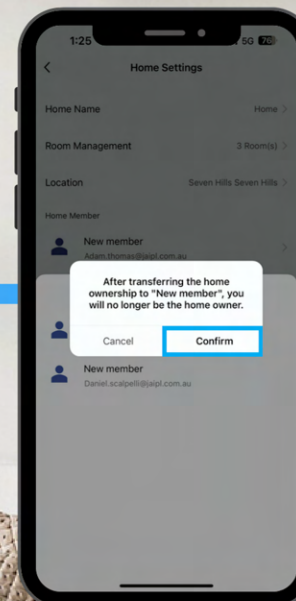





# Adding | Removing Room

1.  
Click on Room Management

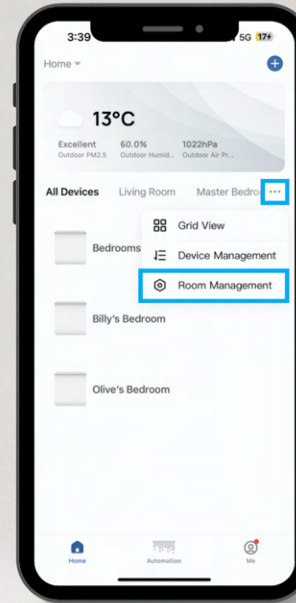

2.  
Click on Add Room

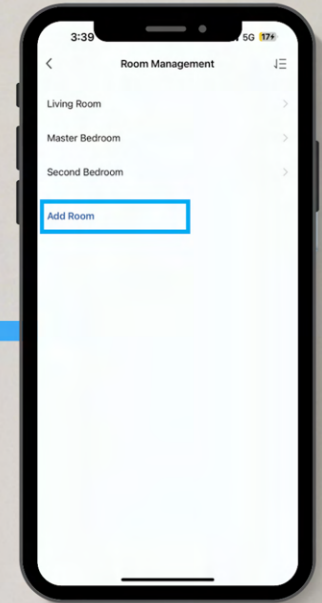

3.

Type in room name and click save

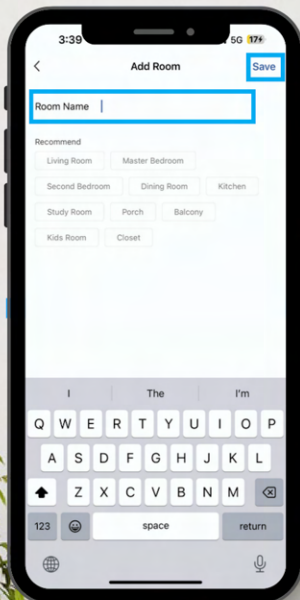

4.

Add other rooms.  
To delete rooms click the lines in the top right corner.

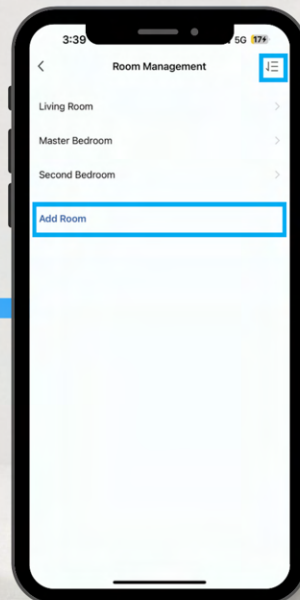

5.

To delete a room, slide it to the left and click delete

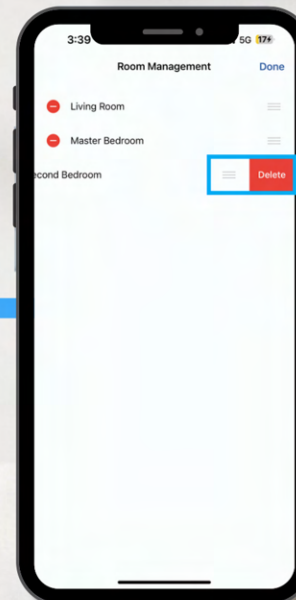

6.

Click Delete and it will delete the room

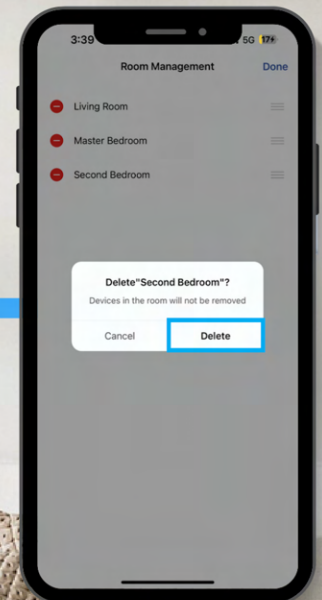





# Adding / Removing Devices From Rooms

1.

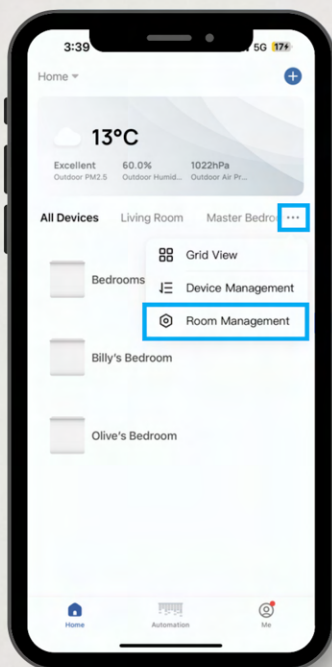

Click on Room Management

2.

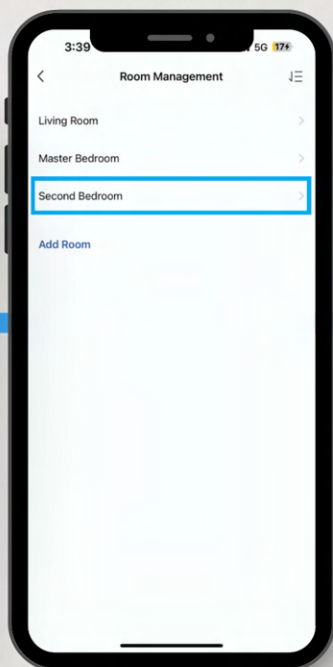

Click on room

3.

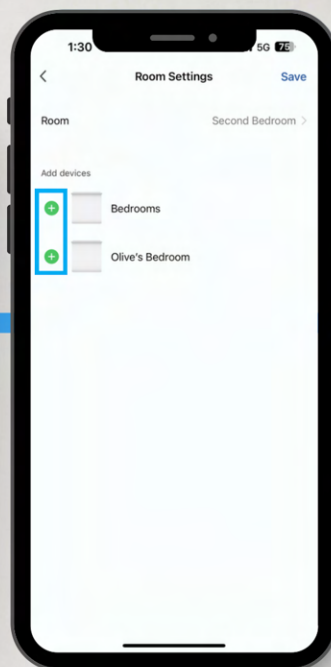

Click on + or - to add or remove devices from the room

4.

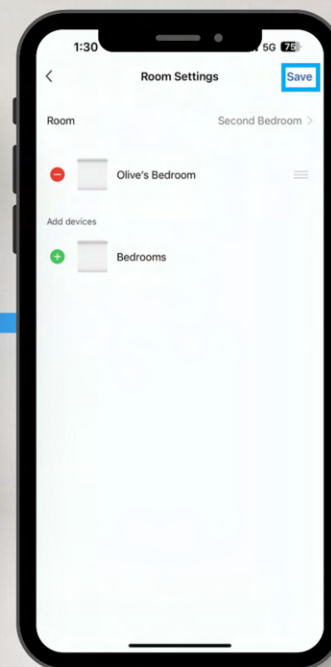

Click save

5.

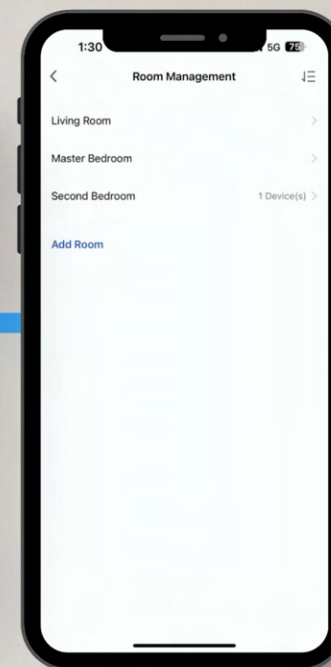

Devices have now been added/removed





# Internal & External Roller Blinds







# Syncing Motor

1.

Ensure you are connected to the locations **2.4GHz** Wi-Fi network before commencing

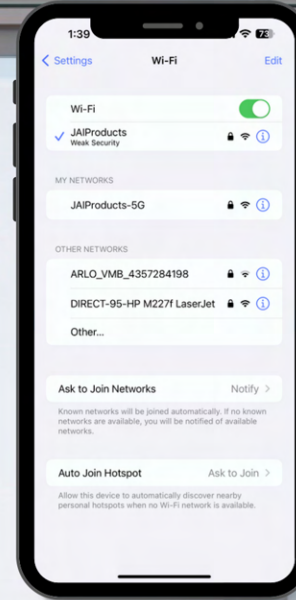

2.

Click the plus button

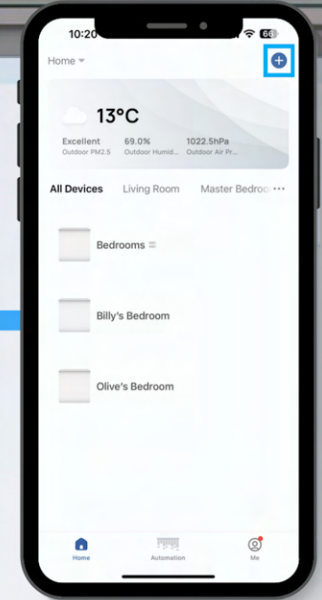

The Wi-Fi's signal strength and existing loading will impact how many motors can be synced simultaneously, we recommend syncing no more than 5 simultaneously.

3.

Click add



4.

Enter Wi-Fi password

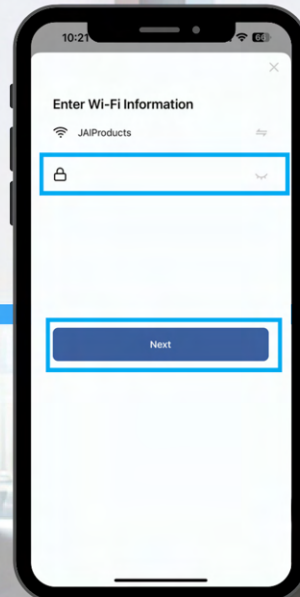

5.

Motors will begin to sync



6.

Click done

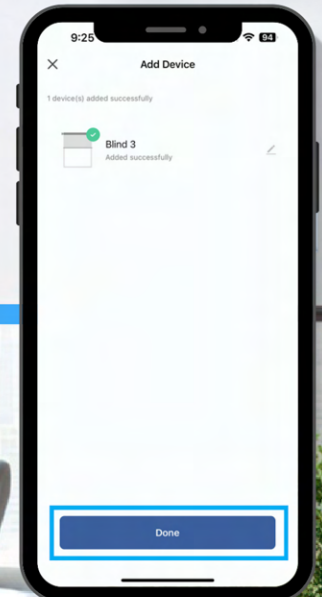





# Product Navigation

Percentage the blind is closed

40%

Live view of blind position

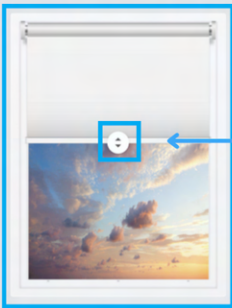

Change device name or icon image | create group control



Control blinds position by sliding up/down



Blind controls

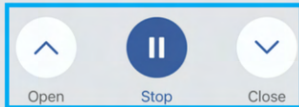

Limit Settings & change roll direction



Setting

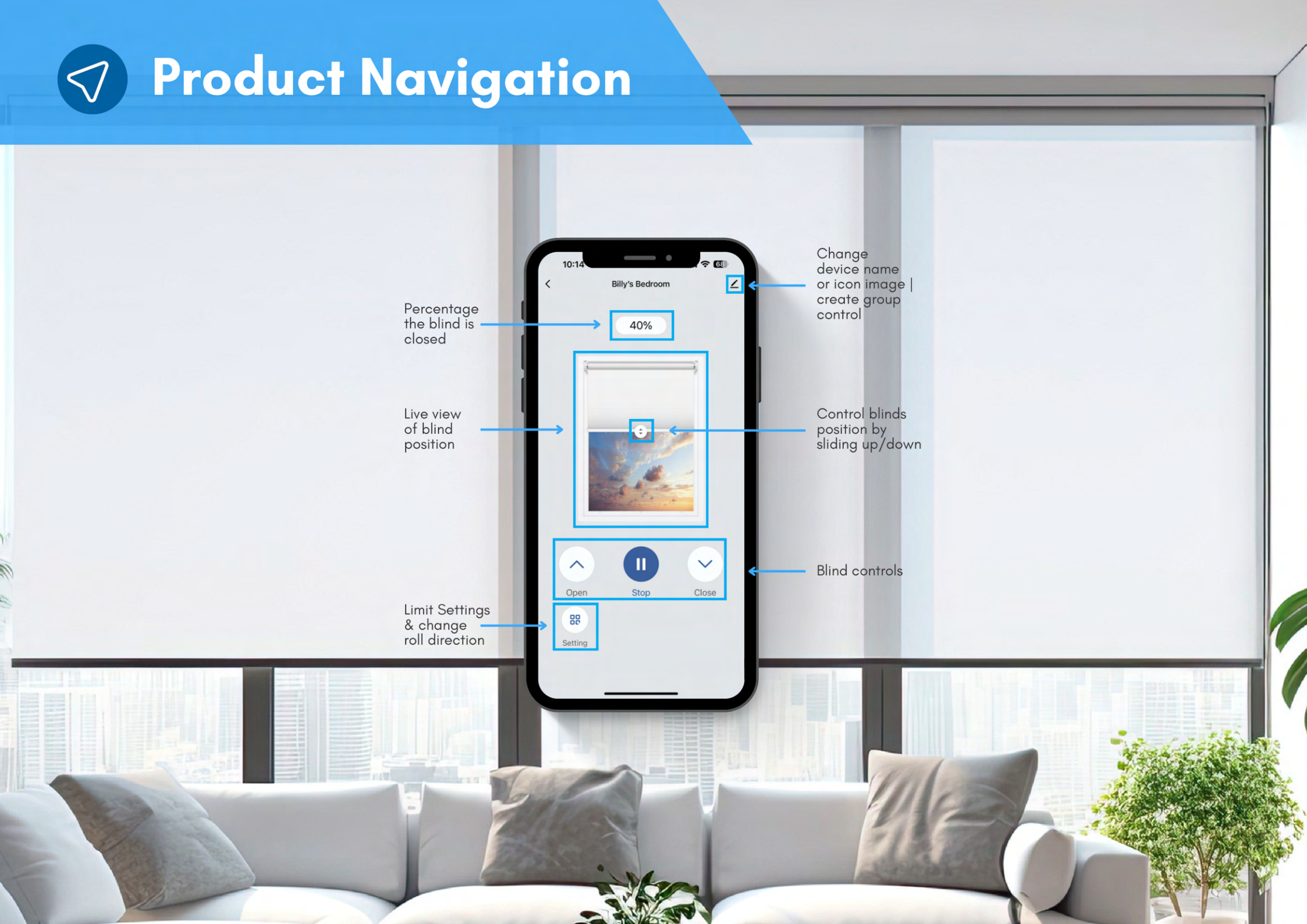





# Naming your Shading System

1.

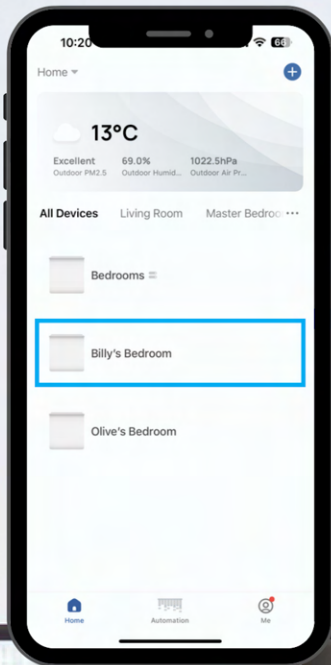

Click on the device

2.

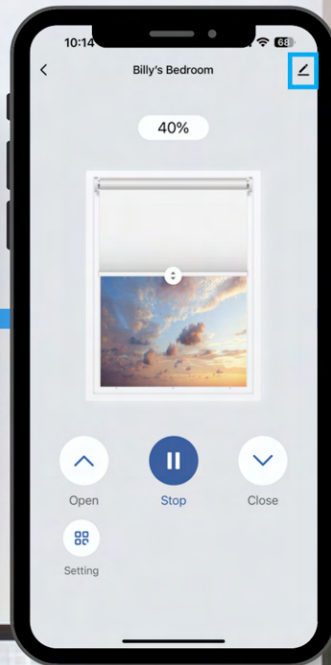

Click on the pen in the right hand corner

3.

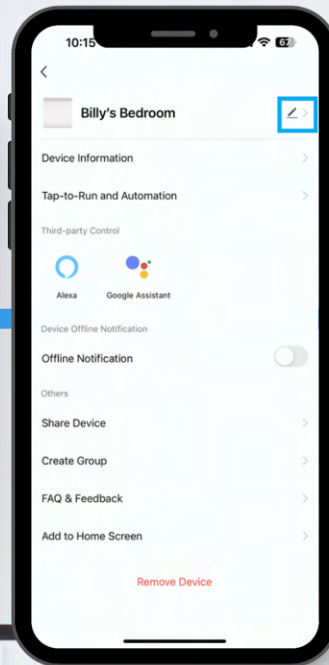

Click on the pen in the right hand corner

4.

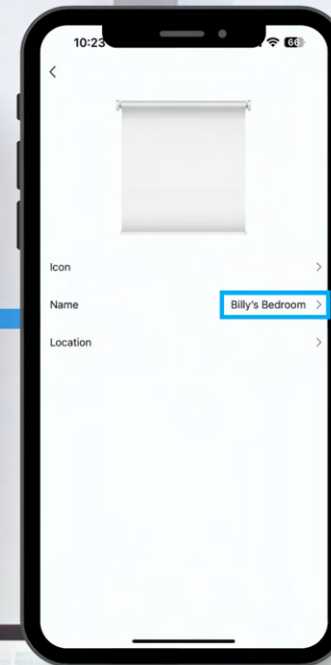

Click on name

5.

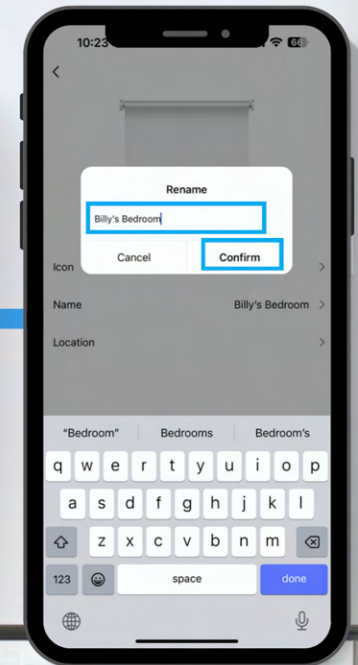

Rename and press confirm



# Reverse Roll Direction

1.

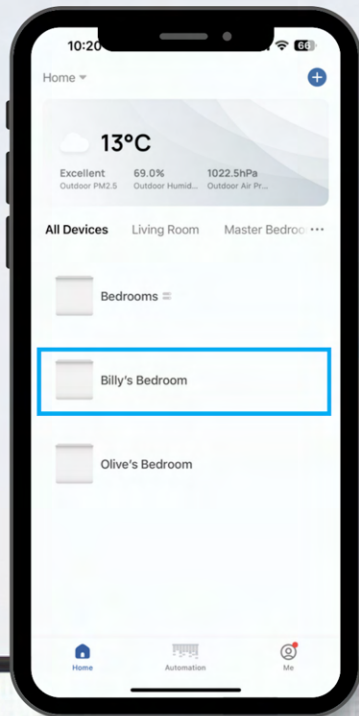

Click on the device

2.

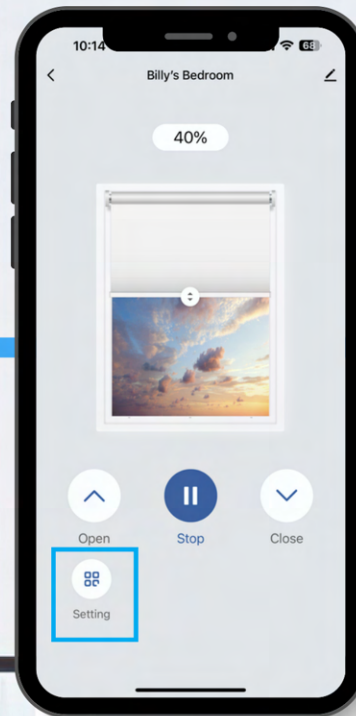

Click on Setting

3.

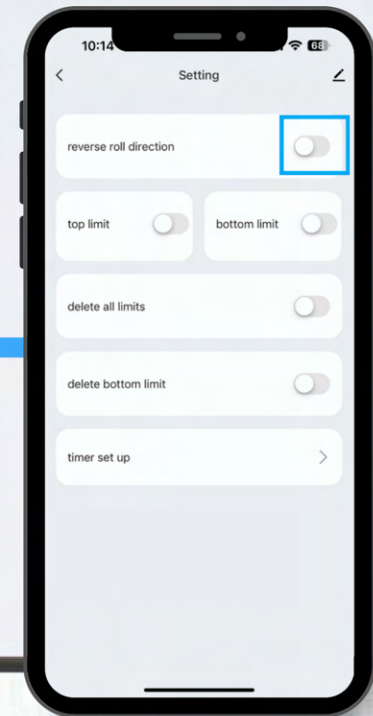

Click on Reverse Roll Direction and the motor will jog





# Setting Limits

1.

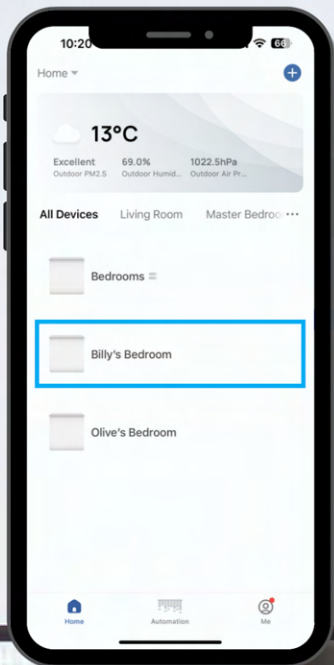

Click on device

2.

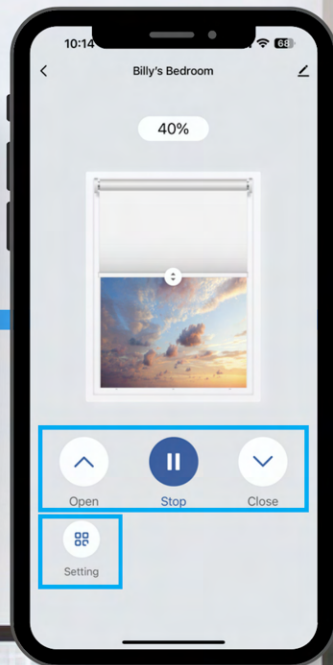

Move the blind to where you want the top limit to be and then click setting

3.

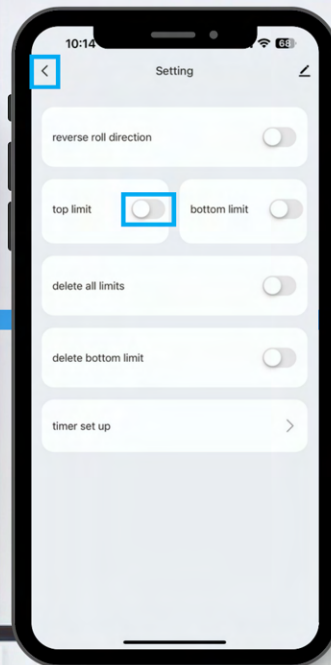

Click top limit, the motor will jog. Then click back

4.



Move the blind to where you want the bottom limit to be and then click setting

5.

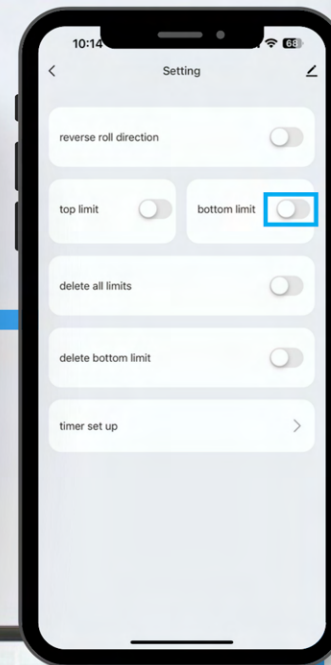

Click bottom limit and the motor will jog

Limits are now set





# Setting Up Group Control

The Wi-Fi's signal strength and existing loading will impact how many motors can be grouped together, we recommend grouping no more than 5 motors together.

1.

Click on device

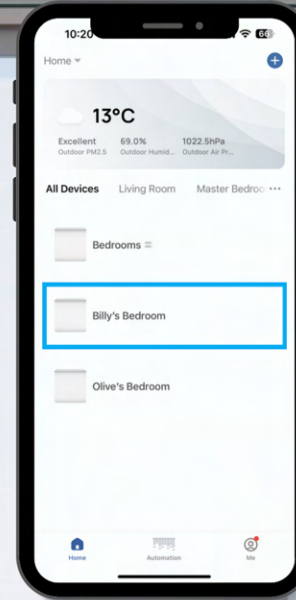

2.

Click on the pen in the right hand corner

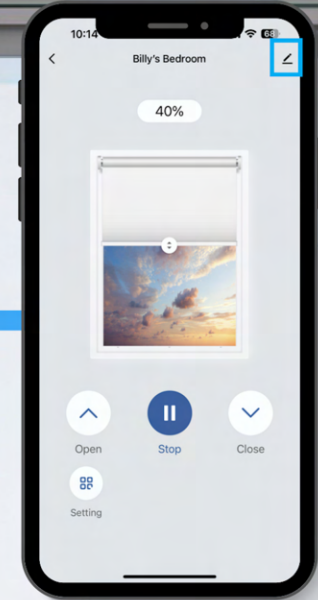

3.

Click create group

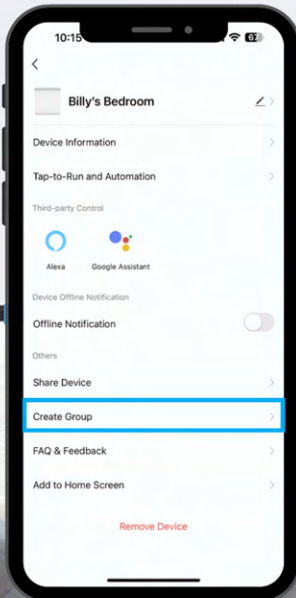

4.

Add devices to the group control by clicking the green +

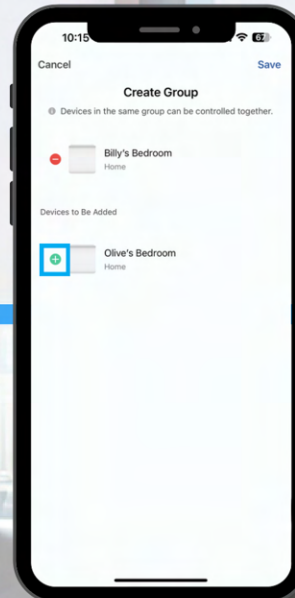

5.

Click Save

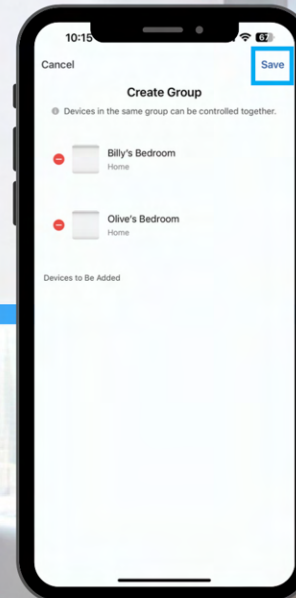

6.

Enter the group name and click Save

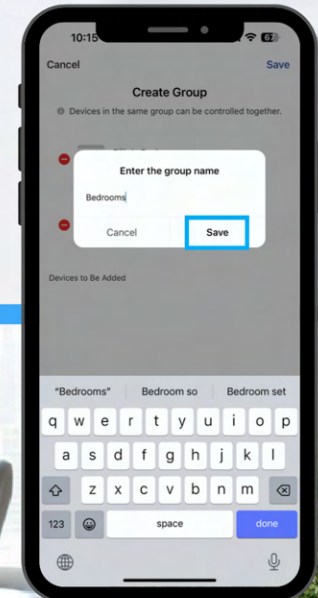





# Timer Set Up

1.

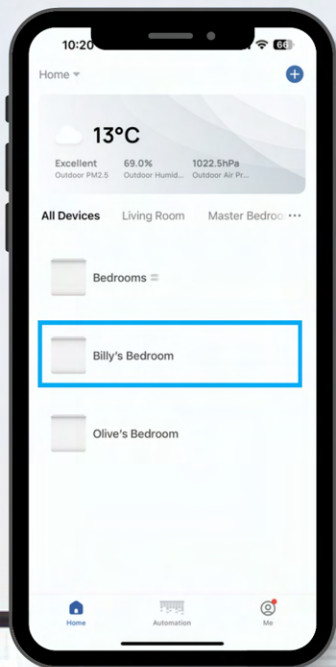

Click on the device

2.

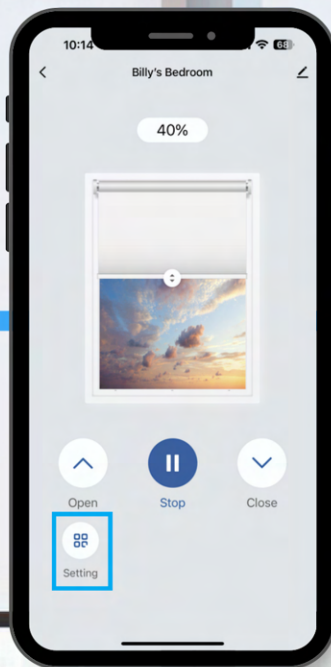

Click Setting

3.

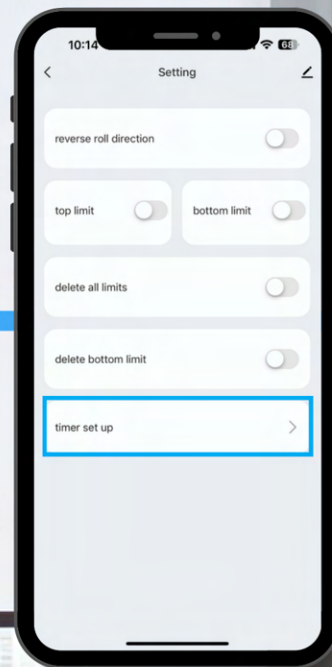

Click timer set up

4.

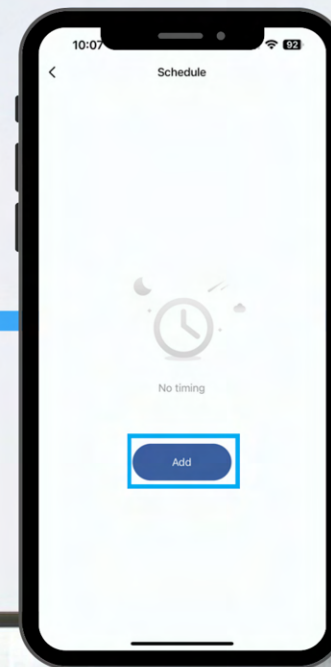

Click Add





# Timer Set Up

5.

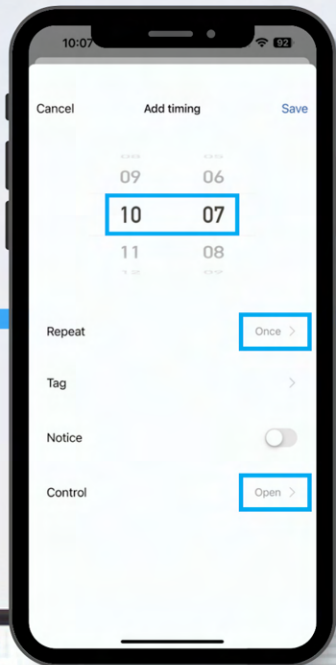

Select desired time

6.

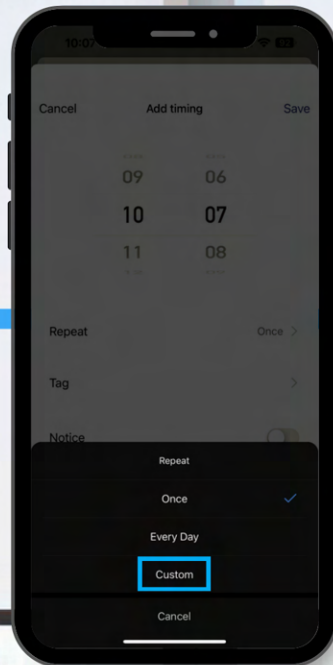

Select Frequency

7.

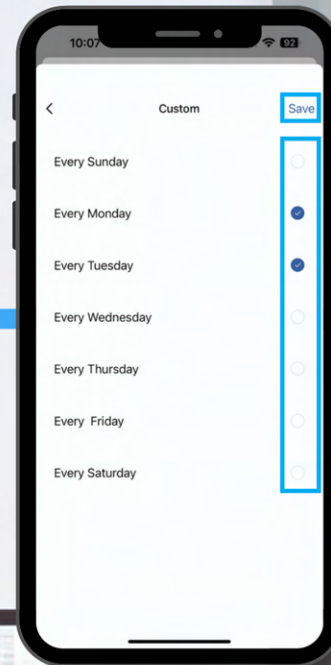

Select specific days and click save

8.

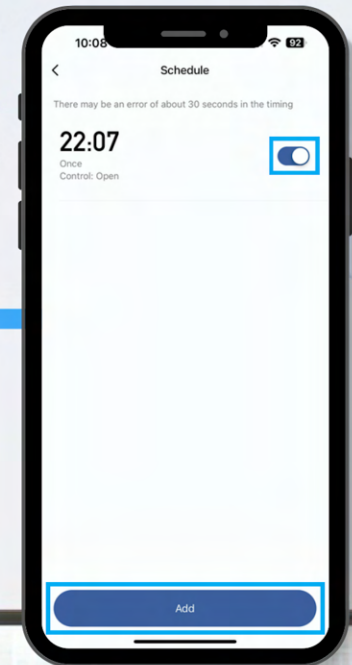

Turn timer function on/off

Click add to set additional timers





# Changing An Icon

1.



Click on device

2.

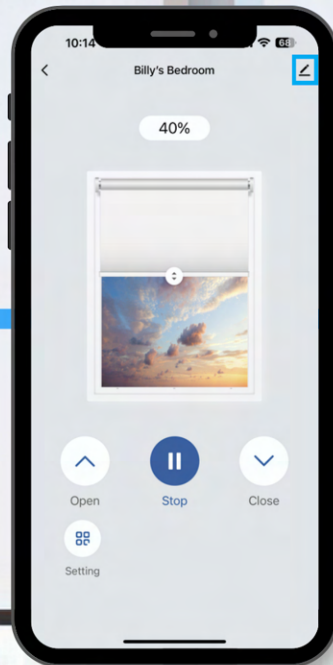

Click on the pen in the right hand corner

3.

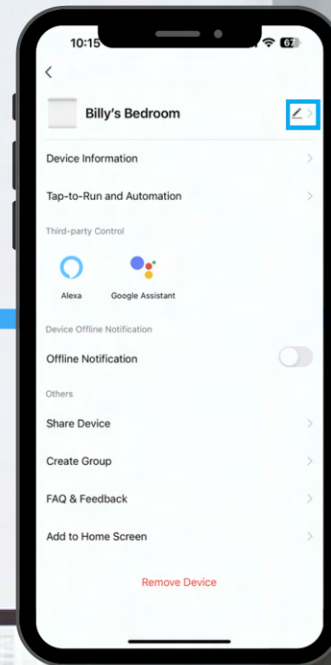

Click on the pen in the right hand corner

4.

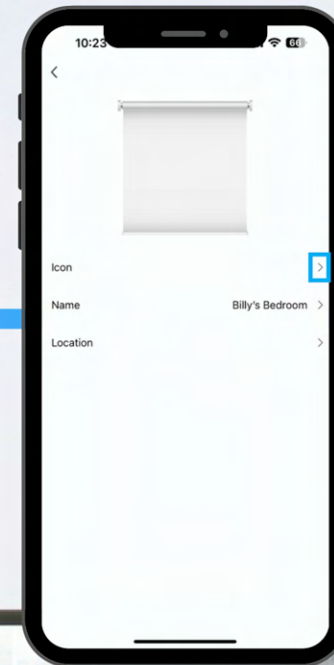

Click on the arrow next to icon





# Changing An Icon

5.

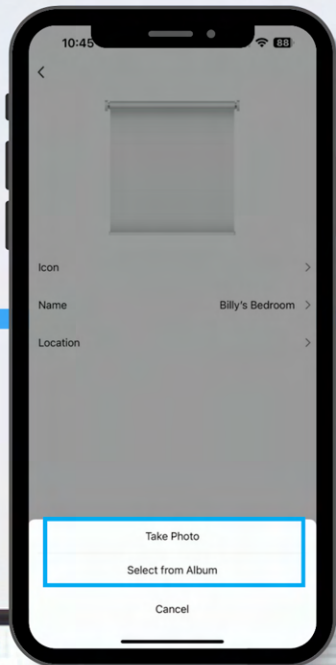

Click take photo or select from album

6.

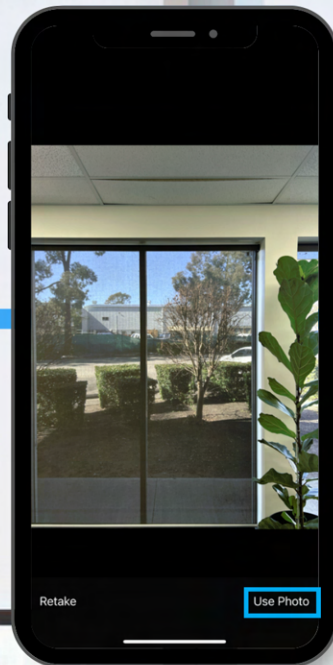

Take photo and click use photo

7.

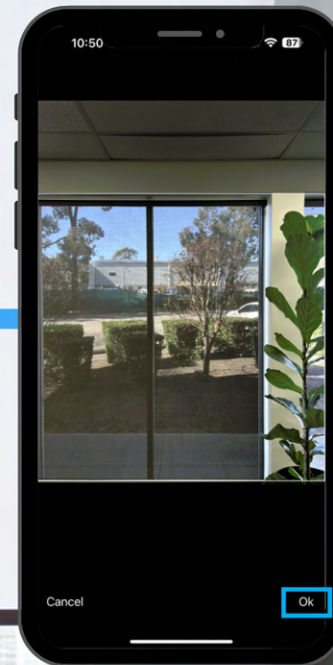

Select active area of image and click ok

8.

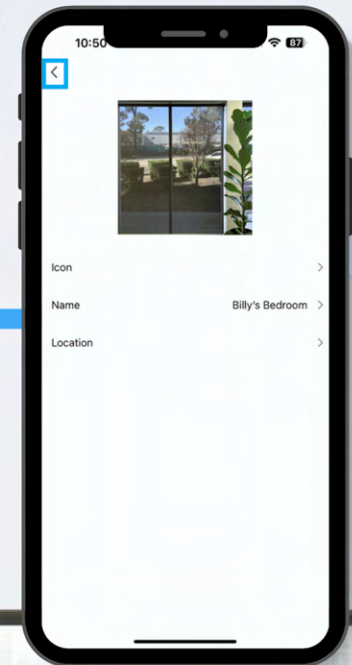

Click on the arrow in the top left corner





# Creating Automation







# Creating Automation

1.



Click on automation tab

2.

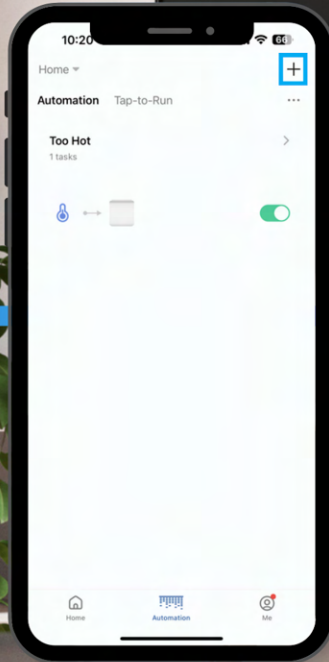

Click the + button in the top right corner

3.

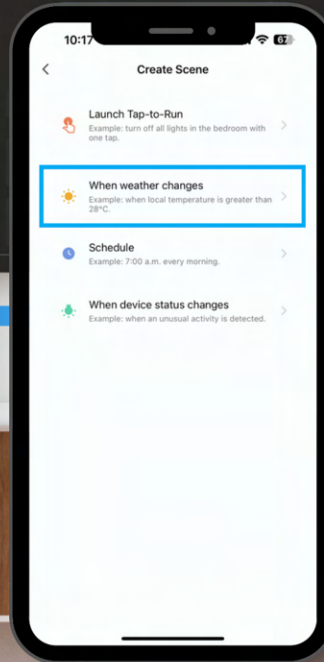

Click on When weather changes

4.

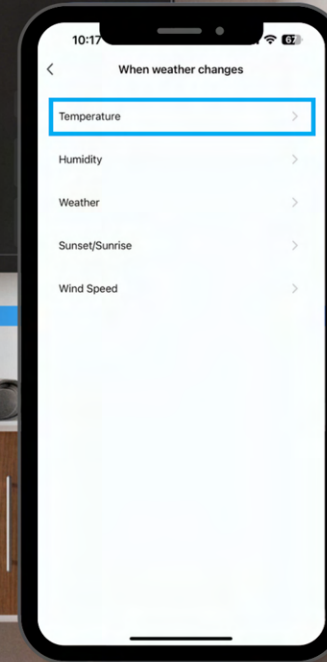

Click on Temperature

5.

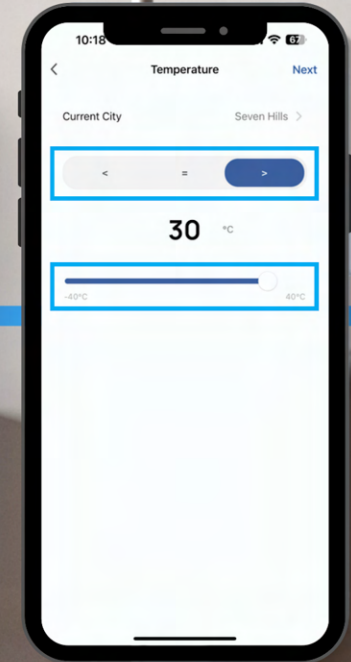

Select above, below or equal to. Then select specific temperature





# Creating Automation

6.

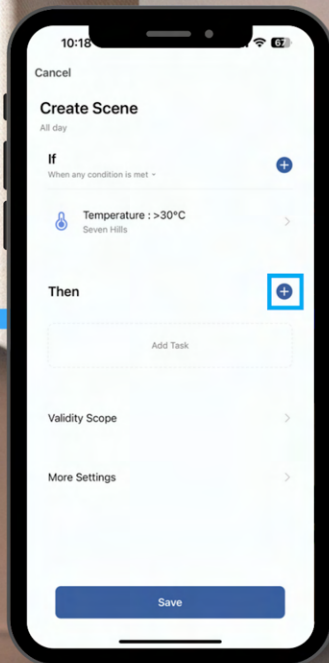

Click the plus sign next to then

7.

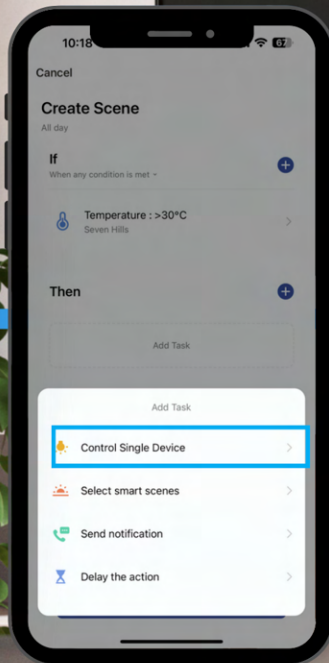

Click on Control Single Device

8.

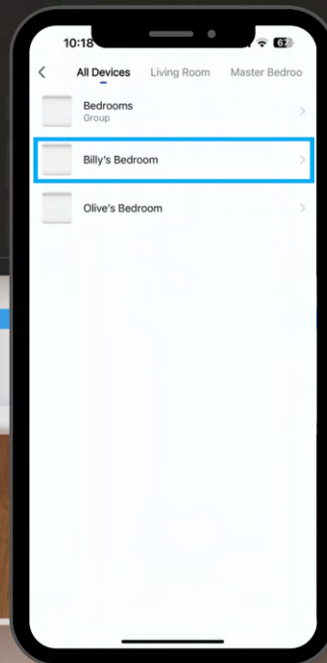

Click on the device or group

9.

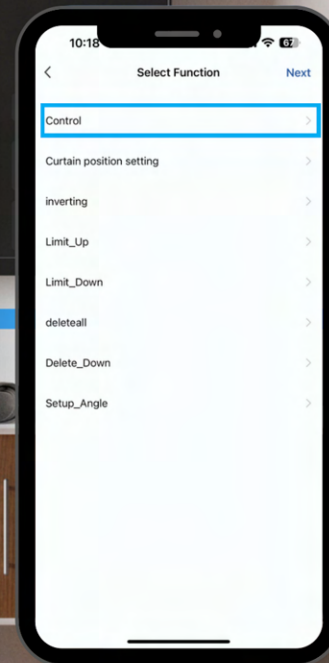

Click on Control

10.

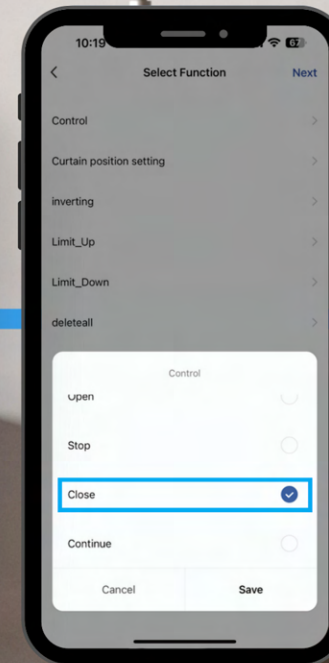

Select the action you want the device to take





# Creating Automation

11.

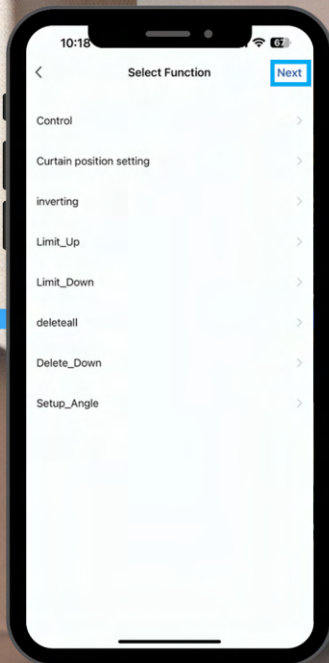

Click on Next

12.

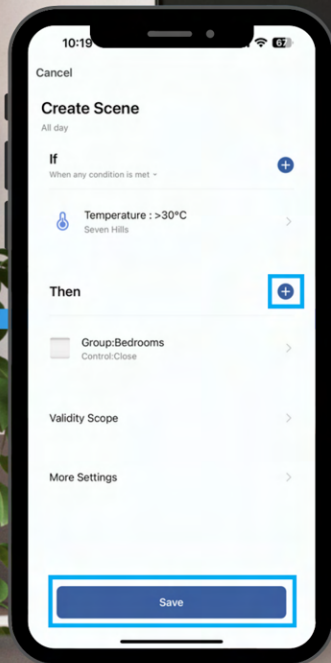

Once you have added all the devices, click save

To add additional devices to the same programming, click the + button

13.

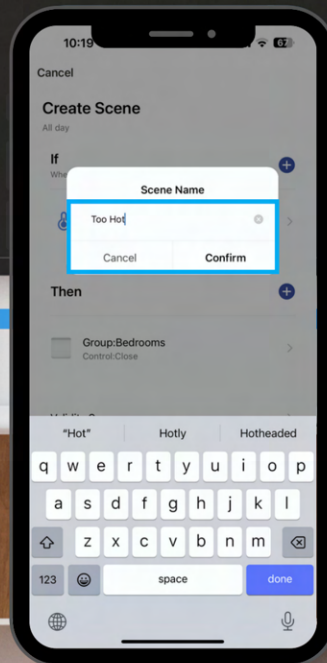

Name the automation

14.

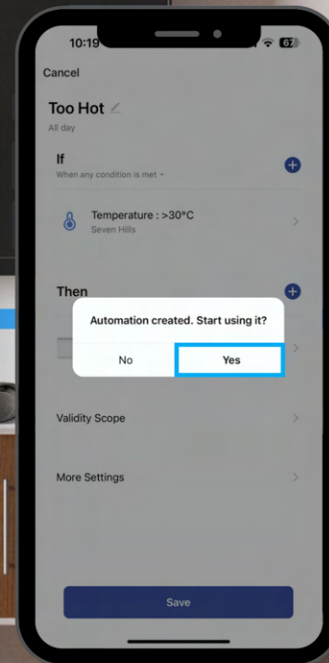

Click Yes

15.

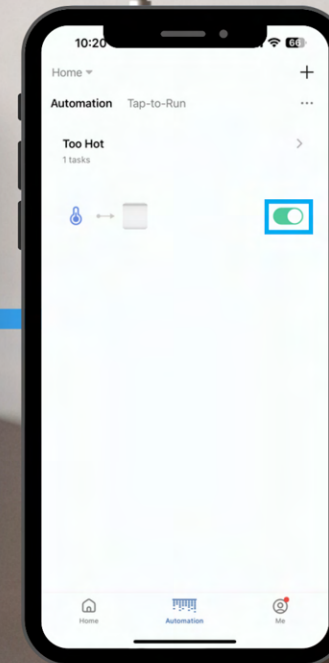

To turn automation on/off